

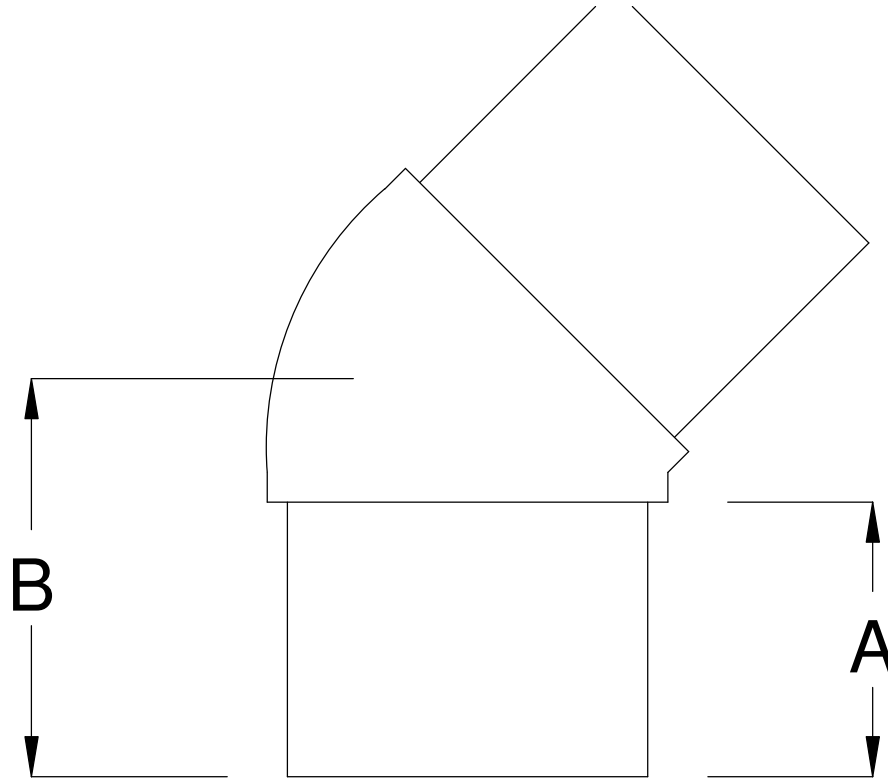

Specified Fittings, LLC

164 West Smith Road • PO Box 28157 • Bellingham, WA 98228-0157 | Email: sales@specfit.com

Bellingham: 360-398-7700 | 360-398-7051 Fax
Stevensville: 406-777-3466 | 406-777-7181 Fax
Mexico (Toll Free): 800-429-1705 | 800-574-1075 Fax



MOLDED 45s		
SIZE	A	B
2"	2.75	3.5
3"	3.5	4.75
4"	3.5	4.75
6"	4.75	6.3
8"	5.5	8.5

TITLE

INJECTION MOLDED HDPE 90-deg ELBOWS
DR7-17
FM 150, 200, 250, 267, 335

DATE

3-21-2019

DISCLAIMER - PLEASE READ

- 1) All dimensions approximate, subject to change without notice
--Angle tolerance is +/- 2 degrees
--All other dimensions to +/- 1"
- 2) This drawing only applicable if a copy is referenced at time of order.
--Without a copy of drawing, fitting construction may differ from that shown.
- 3) Subject to Specified Fittings Standard Terms and Conditions.